

Data Sheet

Recommended Application: Universal

High Energy
4920

Type Designation 4920
 Designation IEC LR20
 System Zn-MnO₂ (Alkaline)
 Shelf Life (Coding)* 5 years
 Nominal Voltage [V] 1.5
 Typical Capacity C [mAh] 16500 (discharge with high-resistance)
 Permissible Temperature Range - 10 °C ... 50 °C
 Weight, approx. [g] 144
 Volume [ccm] 51.3

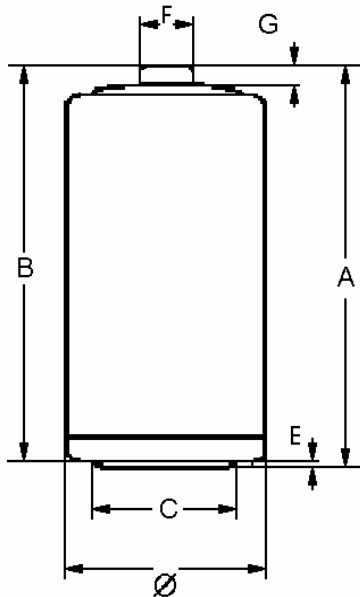

Dimensions [mm] min: max:

Ø	32.3	34.2
A	-	61.5
B	59.5	-
C	18.0	-
E	-	1.0
F	-	9.5
G	1.5	-

Typical Capacities (at 20°C)

Discharge Type	Load	End Voltage[V]	1.0	0.9
4M/15M,8H/D,7D/W Portable Lighting (2)	1.5 Ω	Time [h]	11.60	14.30
		Capacity [Ah]	9.25	11.15
		Energy [Wh]	11.10	13.15
Discharge Type	Load	End Voltage[V]	1.0	0.9
4M/H,8H/D,7D/W Portable Lighting (1)	2.2 Ω	Time [h]	23.45	25.80
		Capacity [Ah]	13.05	14.15
		Energy [Wh]	16.05	17.20
Discharge Type	Load	End Voltage[V]	0.9	0.8
1H/D,7D/W Toy	2.2 Ω	Time [h]	24.55	27.40
		Capacity [Ah]	12.55	13.70
		Energy [Wh]	14.30	15.30
Discharge Type	Load	End Voltage[V]	1.0	0.9
2H/D,7D/W Portable Stereo	600 mA	Time [h]	13.80	17.10
		Capacity [Ah]	8.30	10.25
		Energy [Wh]	9.75	11.70
Discharge Type	Load	End Voltage[V]	1.0	0.9
4H/D,7D/W Radio	10 Ω	Time [h]	115.30	130.60
		Capacity [Ah]	14.45	15.95
		Energy [Wh]	18.30	19.70

* In consideration of typical loss of capacity at storage and application.